

RDC

T2

LGT 1

PROPOSITION D'AMENAGEMENT
surfaces indicatives après travaux

Séjour/Salon	30.37 m ²
Chambre	10.09 m ²
Salle de bains	6.02 m ²
Cuisine	6.89 m ²
<hr/>	
Surface	63.74 m ²

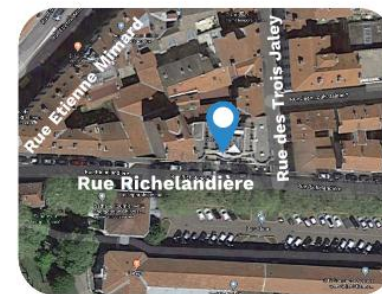
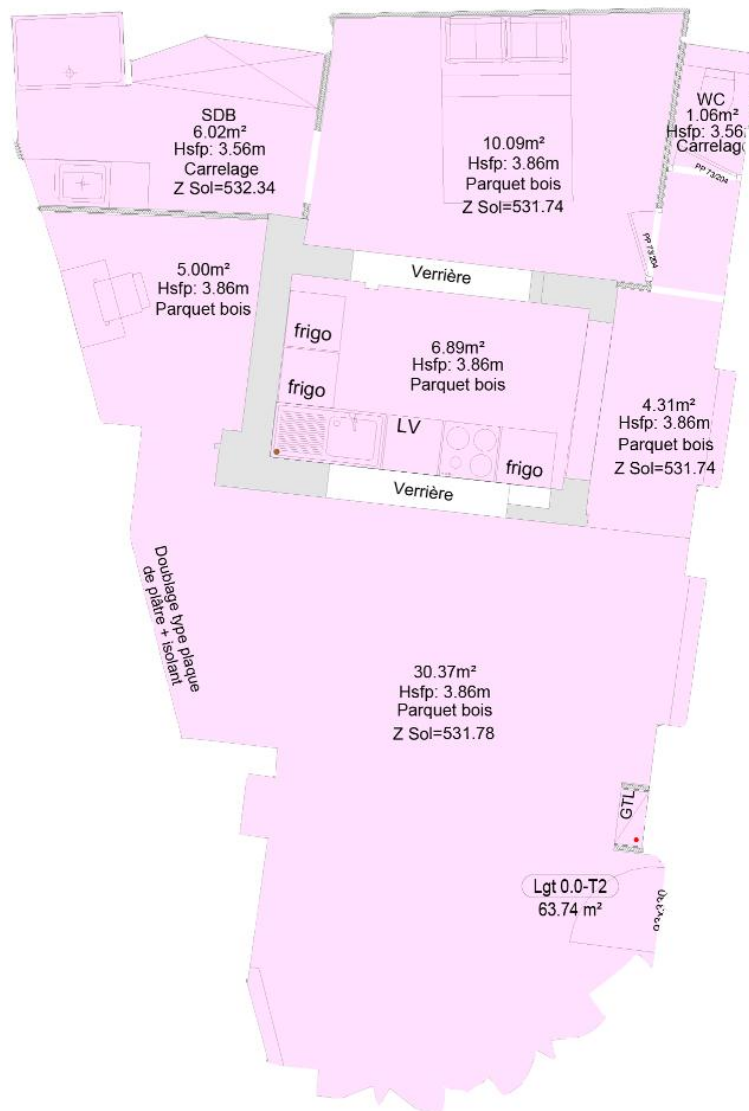

8 Rue Richelandière
42000 Saint-Étienne

